

Highland

RIDGE RV

Range Lite

Serial #: 58TBM0BN7P3ET3070
Model: 242RL RANGE LITE TT

Model Year: 2023 Dealer Name: DENNIS DILLON RV
6772 WEST TARGEE
BOISE, ID 83709
USA

JP014

RANGELT
HIGH
23
B23



58TBM0BN7P3ET3070



Standard Equipment

Optional Equipment

THE FOLLOWING ITEMS ARE STANDARD ON THIS MODEL
AT NO EXTRA CHARGE

OPTIONAL EQUIPMENT INSTALLED ON
BY MANUFACTURER

EXTERIOR

- 5/8" main floor decking
- Door side spray port
- Exterior grill/griddle quick connect port
- Flexible LP lines
- Foldable grab handle
- Fully-walkable roof
- In-frame battery rack
- Magnetic baggage door catches
- Oversized pass-through storage with motion lighting
- PVC roofing membrane (limited lifetime warranty)
- Rain guttering with molded drip spouts
- Rear observation camera prep
- Safety bumper with drain hose carrier and end caps
- Self-adjusting electric brakes
- Side camera prep marker lights
- Solid swing-down entry steps
- Thermal Seal- enclosed, insulated and heated underbelly with fully insulated roof with a PVC roofing membrane
- Tinted safety-glass windows throughout
- TuffShell™ - vacuum bonded laminated construction, reinforced with heavy-duty fiberglass and welded aluminum frames

INTERIOR

- 60" x 80" residential queen bed with storage drawers below
- 75 lb. ball bearing drawer guides
- 81" interior height
- Cable and satellite prep
- Electrical outlets and USB ports in master bedroom
- Flush floor slides with residential vinyl flooring
- Hardwood cabinet doors
- Kitchen sink covers
- Laundry chute in bedroom
- LED interior lighting
- Medicine cabinet
- Powered 12V bathroom vent
- Range hood
- Residential high-rise faucet with pull-down sprayer
- Roller blackout night shades
- Soft closing foot flush toilet
- Stainless steel single basin under-mount kitchen sink
- Tri-fold sofa (select models)

CUSTOMER CONVENIENCE PACKAGE (Mandatory)

- 15,000 BTU roof mounted A/C
- 2-30 lb. LP bottles
- 3-burner range with 17" oven and flush mount glass cover
- 8 cu. ft. gas/electric refrigerator
- Dome style digital TV antenna with Wi-Fi prep
- Enclosed exterior docking station with black tank flush
- Entrance door with screen door, window and magnet door catch
- EZ-store detachable cord
- Gas/electric water heater
- JBL® Aura Cube stereo with Bluetooth® and miZONE™ technology
- JBL® Premium indoor and outdoor multizone speakers
- Microwave
- Molded front cap with LED lighting and stoneguard protection
- Nitrogen filled radial tires with aluminum rims
- Pop up wireless and USB charger in bedroom
- Power awning with LED lighting
- Power tongue jack
- Pressed membrane countertops
- Rear roof access ladder
- Smart HDTV

Base price

- USA Standards
- Customer Convenience Package
- Xtend Solar I Package
- 10 Cu. Ft. 12V Residential Refrigerator
- Electric Stab Jacks
- Theater Seats
- Dinette

UNIT TOTAL

49,

DEALER INSTALLED OPTION



Manufacturer's Suggested Retail Price

\$49,195.00

TOTAL AMOUNT DOES NOT INCLUDE STATE AND LOCAL TAXES OR LICENSE FEES. THE PRICE SHOWN ABOVE MAY OR MAY NOT BE REPRESENTATIVE OF THE ACTUAL SELLING PRICE OF SIMILAR RECREATIONAL VEHICLES IN YOUR AREA.

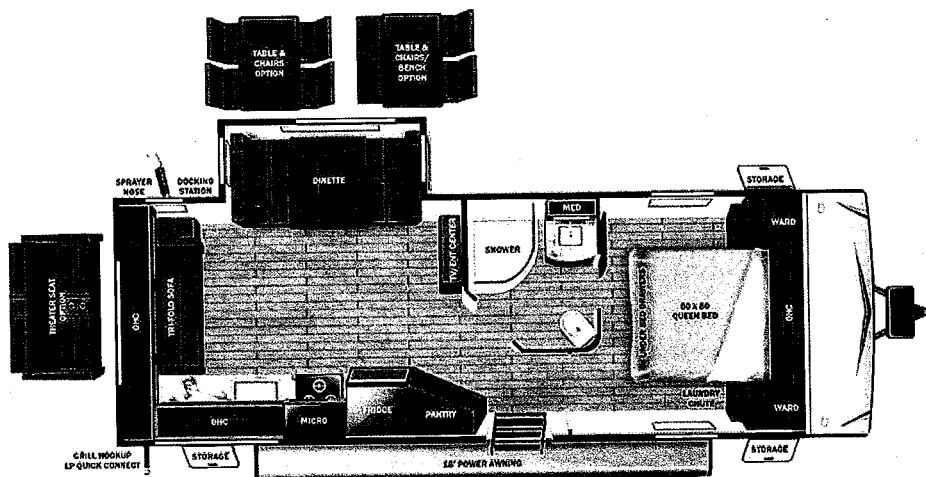

VEHICLE

23.00
n/c

30.00
93.00

93.00
93.00
93.00
n/c



UVW
5725 lbs



Sleeps



Length
28' 10.13"

DIMENSIONS

Exterior height:.....132.25"
Exterior width:.....96.63"

WEIGHTS

GVWR:.....7000
GAWR (front):.....3500
GAWR (rear):.....3500
Approx. Gross Cargo Carrying Capacity (GCCC):.....1275

CAPACITIES

Fresh water tank (gals.):...45.00
Gray water tank (gals.):...29.00
Black water/toilet tank (gals.):...29.00
Propane (lbs.):.....60
Propane (gals.):.....14
Water heater (gals.):.....6.00

SEATING & SLEEPING

TIRES

Tire size (front):.....ST205/75R14D
Tire size (mid):.....
Tire size (rear):.....ST205/75R14D

15.00

Some dimensions may be rounded and may vary from the actual dimensions
Weights may be estimated calculations and may vary from the actual weight - refer to the vehicle weight labels for actual weights
Floorplans, features and specifications are subject to change without notice.

